

Release Notes ViewPoint 1.101

Date: 2020-09-29

Current Release Version: ViewPoint 1.101

Previous Release Version: ViewPoint 1.008

Minimum Android version required: Android 6.0 (Marshmallow) (SDK 23)

- Fixed a bug - When running a Multi-Line project with time as trig source, the start and stop button did not show up in the top toolbar.

Previous Version History

ViewPoint 1.100

Non-Save Mode

A “non-save mode” has been added to the App, as shown in **Figure 1**. When running in this mode, only the latest profile is saved. When pushing the play button, the previous profile will be deleted. The profiles in this mode are held in the folder “ViewPoint Data/Non Save Mode”.

A PDF or KMZ will not be created in this mode. Screenshots will be saved as usual in the “ViewPoint Data/Non Save Mode/Export” folder.

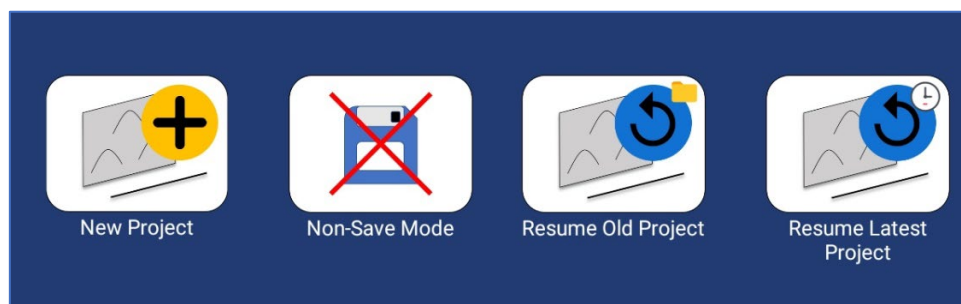

Figure 1 ViewPoint project modes

Storage

Increased Stability

The functions that write data to files during measurement have been improved so that all files are more frequently updated and saved to the internal storage. This improvement will decrease the risk of data loss if something unexpected happens, e.g. a system crash.

Data Folder

The “XOver Data” folder is renamed to “ViewPoint Data” with this version, and the user will be notified about this in the App.

Clear ViewPoint Data folder

From the user preferences menu, it is now possible to see the available storage space left on the Android Device. You can also clear the whole “ViewPoint Data” folder from there, as shown in **Figure 2**.

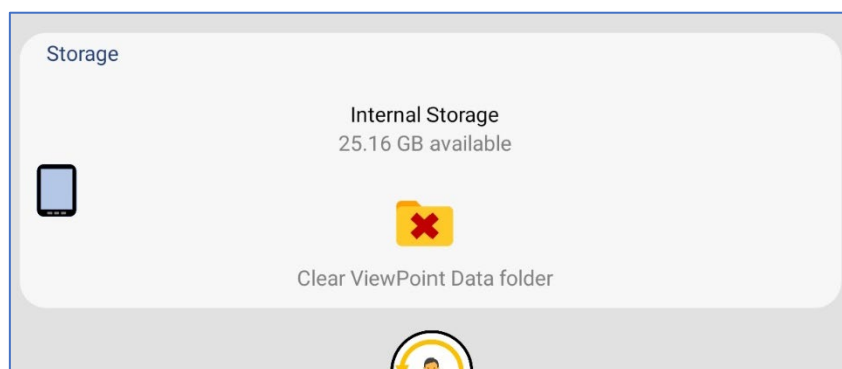

Figure 2 Android device storage status

Storage Control

When starting a new profile (pushing the play button), the App will automatically check if the available storage exceeds 500Mb. If not, the measurement will not start.

Current Date

By default, the current date is added to the project name when starting a new Single Line Project. For example, if the chosen project name is “Jonathan”, then the project name will be “Jonathan_YYYY-MM-DD” when this option is enabled.

You can enable/disable this option from the Single Line Project menu.

File Explorer

Delete Files/Folders and individual Profiles

From the file explorer in the App, it is now possible to delete folders, files, and individual Profiles. Press and hold the item in question, and the delete option will pop up, as shown in **Figure 3**.

Note – when deleting a profile, **all** file associations for that specific profile will be deleted (i.e. .iprh, .iprb, .mrk, .cor, .gps, and .time).



Figure 3 Delete option in file explorer

Open Pictures

It is now possible to open pictures (screenshots, etc.) from within the file explorer in the App.



Cursor Lock

If the cursor lock was on when pushing the stop button, then it will automatically turn on when pressing the play button again.

Bug Fixes

- When running the system in an environment with a lot of Wi-Fi disturbances, it was possible (although rare) that the App would “freeze” and then crash. Under such conditions, the GPS-symbol turns red, the data collection stops, and the user interface fails to respond to commands, and the App crashes. This bug is now fixed!
- The “center current position” function in the Map View slowed down the speed of the App dramatically. When adding a significant number of markers to the map (30 +), the performance reduced to the extent that the user interface stopped responding, leading to the App crashing. This bug has now been fixed!
- In ViewPoint 1.008, the GPS mode “External + Time Pulse” used “Unix LF” line separator when writing data to the coordinate file (.cor). This has now changed to “Windows CRLF” to improve the interpretation of saved coordinate data.
- There was a bug that slowed down the speed of the App when opening large projects with hundreds of profiles. In the worst case, the App crashed. This bug has now been fixed!

ViewPoint 1.008

- Fixed a bug that could impair the GPS accuracy when using the GPS mode “External + Time Pulse”.

ViewPoint 1.004

- Fixed a bug that caused the App to crash under special conditions when using the GPS mode “External + Time Pulse”.

ViewPoint 1.0

- Renamed the App from IPR App to ViewPoint.
- New App icon to support the name change
- New feature added called MapView with supporting functionality:
 - User preference activation
 - Tracks and markers
 - Current position
 - Map screenshot
 - Map type and filter
 - Markers and marker management
- New feature added called Project Overview with support to show all project locations (with GPS data) on a map.
- Renamed PDF Report to PDF Summary Report
- Added disclaimer text to the PDF Summary Report
- New feature allows the user to upload their company logo for inclusion in the ODF Summary Report.

- Auto screenshots of the map added to the PDF Summary Report.
- Operator initiated screenshots are now automatically added to the PDF Summary Report.
- Markers can now be grouped according to type or by ID in the PDF Summary Report
- Compression added to reduce the size of the PDF Summary report with a factor of >10.
- KMZ export function is added to create automatic kmz files including tracks, markers and auto screenshots of the markers in the radargram. The KMZ follows the KML standard and can be opened in Google Earth.
- Redesign of header toolbar:
 - New channel selection buttons
 - Navigation buttons for profiles within the same project
- New option to choose whether to generate a PDF/KMZ file when existing a project.
- Redesign of the 'upgrade Firmware/FGPA' function
- Bug fixes:
 - When changing the screen orientation, the default language was loaded. This is now fixed.
 - Sometimes when the Android back navigation button was pressed, the App did close when it was supposed to go back to the previous screen.
 - Sometimes data was written to the time file when it was not supposed to. From now, data will only be written to the time file when the GPS mode is set to "External + Time Pulse".
 - The .cor file was not written to in real time. Which could have the impact that the GPS data could be lost if the App crashed. From now the *.cor file will be written in real time.
 - The vertical scale for the LF-channel had incorrect position in HF/LF mode.
 - The Reference Line Marker did not adjust its position correctly when the radiogram was zoomed.
 - The red backup cursor was "jumping" when you had scrolled back more than a screen width in the data, with help of the wheel, and was going forward again.
 - The millisecond field in the .time file could in some rare situations be >999. When that happened the .cor file could be corrupted.

IPR 1.130

- User Preferences updated to include an option to select the language.
 - English (Default)
 - French (Google Translated)
 - Swedish

Note: the PDF-field report and the help window is always in English.
- User Preferences updated to include an option to activate Auto Zoom.
 - When starting a new measurement (pushing the play button), the zoom will automatically be adjusted to fill the screen. But it will not over scan. The current zoom factor will also be kept when you stop the measurement.
- New feature added to select the default marker standard from User Preferences.
- Malaysian JUPEM standard added to the list of default marker standards.
- Button added to the header toolbar to change the channel selection. This replaces the previous screen gesture (double-tap).
- Manual control popup window added and includes directional buttons for controlling the cursor, scroll, set marker and zoom.
- Hyperbola and Depth to Target Popup Window now allows the user to adjust the position of the cross-hairs without closing the window.

- The positioning of all Popup Widows is now saved so the last position becomes the default placement position when reopening.
- Screenshots in Dual Frequency Mode are now possible and will also be saved to the PDF Report.
- A new Wi-Fi Connection Warning dialogue is added to warn the user if the Wi-Fi connection is lost during an ongoing measurement.
- Update to marker indexing in old projects so that the marker indexing will now start from the last marker index in the project rather than 1.
- Fixed a bug to restore the gain and contrast parameters when starting a new profile.

IPR 1.120

- Redesign of the multi-project mode.
- The App now prompts for default wheel type when connecting to an Antenna for the first time after installation/upgrade.
- Custom wheels will no longer be deleted after a factory restore.
- A new Direct Drive Cart option is added to the default wheel list, while the older style cart and wheel encoder is renamed Belt Drive Cart.
- Bug fixes:
 - The built-in file browser sometimes showed doublets of profiles.
 - The App could crash when adding a new wheel.
 - The Field Report always showed APWA standard.
 - Default and custom wheels were not saved properly in the antenna, which caused that there sometimes was doublets of the same wheels or that some wheels were missing in the list.
 - When you changed the “sample” (max depth) parameter in the settings menu, the App and the antenna could “freeze” when a new measurement was started with this new parameter.

IPR 1.116

- Single Line Project is now handled more like a project, so files are saved in subfolders, following the same logic for Multi Line Project.
- New options added when starting a project – start a new project, resume the latest project, or resume an old project.
- The Settings menu is renamed to Antenna Settings and has been redesigned to be more user friendly.
Note – there is a switch called “Show Advanced Settings”. When its deactivated, just the most necessary settings are displayed.
- A project folder can now be zipped from the App’s file explorer. Do a long press on the project folder that you want to zip, and select “Zip Project”.
- The GPS symbol will now always be displayed. If there is no GPS signal, the GPS symbol is red.
- The PDF Rreport function is adjusted to the new project structure, so one report is created for each project.
- From the file explore in the App you can now see the size and type of the project.
- The filter window can now also be displayed and used when showing both channels at the same time. And you can also have it opened, and on the same time use other UI.

- After a new installation/upgrade of the App, its necessary to make a factory reset after you have connected the antenna. This is now done automatically.
- Bug fixes:
 - Problems regarding zoom tilt and scrolling are fixed.
 - .cor file was not created if the GPS didn't have signal when pushing play button.
 - The sec time field showed "-1" instead of 0 in the .time file, when flipping over from 59.
 - Not possible anymore to set a marker outside the radiogram.
 - PinPointR antennas will now be identified correctly.
 - The App couldn't open projects that only contained LF profiles.
 - The thumbs of the gain/contrast seekbar in the filter menu looked very strange in Multi Line Dual View mode.
 - When opening a profile with markers in CrossPoint, "user comment" was printed out for all markers.

IPR 1.104

- Improved performance on all devices.

IPR 1.103

- The App has a new zoom functionality. The new function will zoom in both horizontal and vertically direction, and the zoom factor is displayed in the left bottom corner (x5 max).
- Both the horizontal and vertical scroll is now controlled with just one finger, instead of three! And the horizontal scroll is much smoother than before.
- Some of the settings in the old Settings screen is moved to the new Preference screen, and some new preferences regarding the PDF field report is added.
Note – the Preference Screen is always available even when the antenna is disconnected.
- The PDF report is now adapted to also be useful for Multiline projects. When a Multiline project is finished, a report will be generated including all markers and screenshots from the entire project. When starting a new line, the indexing of the markers will continue from its last position.
 - To reduce the number of pages in the report, Markers are now grouped by color – one table for each color and channel.
 - Screenshots of all markers will automatically be printed out in the report (exactly as many screenshots as needed to show all markers are printed). Operators screenshot will also be printed as before.
 - The field report can now be opened directly from the file window in the App. The pdf will be opened in an external pdf reader.
- Bug fixes:
 - The Imperial measurement system now works as expected in all places in the App. You can switch between Metric and Imperial from the new Preference Screen.